

Fittings - Roll Mechanical

Coupling Model 1N

Flexible Coupling

- A flexible coupling accommodates pipe deflection and or non-alignment: If nominal diameter <DN200, deflection angle is $\geq 1^\circ$; if nominal diameter \geq DN200, deflection angle is $\geq 0.5^\circ$ but $< 1^\circ$.
- The C-shaped rubber gasket provides excellent self-sealing capabilities in both low and high-pressure services as well as under certain vacuum conditions.
- The design and construction of the coupling with elastomeric gaskets can provide significant noise and vibration absorption as well as seismic stress.
- Coupling keys engage the full circumference of the grooves and provide significant pressure and end load restraint against pipe movement from internal and external forces.
- For use in services up to 3450kPa.

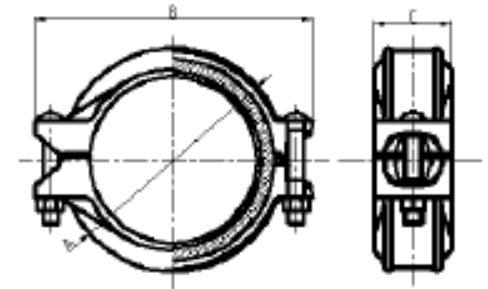

Material Specification

Size Range:	DN25 to DN300
Max. Working Pressure:	300psi
Body:	Ductile iron
Gasket:	EPDM
Finish:	Red painted or galvanised
Approvals:	FM approved and UL listed

Nominal Size DN	Pipe O.D mm	Working Pressure kPa	Dimensions			Bolt Size No.-Size
			A mm	B mm	C mm	
25	33.7	3450	55.5	94	42	2-3/8X55
32	42.4	3450	65	104	42	2-3/8X55
40	48.3	3450	72	109	45.5	2-3/8X55
50	60.3	3450	84	130	45.5	2-3/8X55
65	73.0	3450	98	143	45.5	2-3/8X55
65	76.1	3450	101.5	148	45.5	2-3/8X55
80	88.9	3450	115.5	165	45.5	2-1/2X55
100	114.3	3450	145.5	197	45.5	2-1/2X70
125	139.7	3100	170	238.5	50.8	2-1/2X70
125	141.3	3100	170	232	51.5	2-5/8X80
150	165.1	3100	197.5	263.5	50.8	2-5/8X80
165	168.3	3100	202	270	50.8	2-5/8X85
200	219.1	3100	260.0	351.0	52.5	2-3/4X85
250	273.0	2070	318	395.0	60.5	2-3/4X115
300	323.9	2070	368.5	458	63.5	2-7/8X120

- Nominal size: couplings and fittings are identified by nominal diameter of the pipe (DN) in millimetres.
- Pipe OD: Actual outside diameter of the pipe is in millimetres
- Working Pressure (Cold Water Pressure) and End Load are total, from all internal and external loads, based schedule 40S, Sch 10 & Sch 5 Stainless Steel Pipe to ASME B36.19 Welded & Seamless Dimensions and Mass as listed in the Stainless Steel Pipe Brochure.
- WARNING: FOR ONE TIME FIELD TEST ONLY, the Maximum Joint Working Pressure may be increased to 1.5 times the figure shown in table.
- WARNING: Piping systems must always be depressurised and drained before attempting disassembly and or removal of any components.

